



BRODOSPLIT

PRODUCTS



SEARCH AND RESCUE CRAFT

YARD 501 - "PLANAC"
YARD 502 - "UMAG"
YARD 504 - "MARJAN"

Owner:
REPUBLIC OF CROATIA
MINISTRY OF THE SEA, TOURISM,
TRANSPORT AND DEVELOPMENT

MAIN CHARACTERISTICS:

Length, over all	14.45 m
Length, hull without platforms	13.10 m
Breadth, max. without fenders	4.64 m
Draught, max.	1.15 m

Fast boat's primary task is surveillance at sea and search & rescue.

Fast boat is built according to rules of Croatian Register of Shipping (CRS) for boats for commercial purposes and according to Germanischer Lloyd (GL) rules. It is made of sea resistant aluminium alloy (AlMg4,5Mn), longitudinally framed, welded construction. Damaged stability requirements are satisfied. Two four-stroke diesel engines, turbocharged, electrically started, mechanically regulated RPM, maximal engine brake power 2 x 305 kW, driving 5-bladed propellers through reversible V-type gearboxes, enable service speed of 26 knots.

Propulsion plant is remotely controlled from wheelhouse control console. Wheelhouse (with all round visibility) and

accommodation spaces are air-conditioned. Electrical power is provided from batteries (24V DC) and from diesel generator (220V, 50Hz, 8kW). Boat is equipped with radio equipment (1 VHF/DSC, 1 VHF, 2 VHF portable, 1 AIS transponder and 1 NAVTEX). Navigation system consists of: 1 radar, 1 GPS, 1 magnetic compass, 1 echo sounder/speed log.

Accommodation is provided for 2 crewmembers and 12 passengers/survivors. In addition, there are 2 single-berth cabins and 1 auxiliary berth.

Fuel tanks capacity enables range of 400 nautical miles (NM), at 23 knots speed.

Stores enable 7 days autonomy.

This boat can also be used as oil spill control boat or fire fighting boat, by adding specific equipment at working deck at stern.



BRODOSPLIT - BRODOGRADILIŠTE SPECIJALNIH OBJEKATA d.o.o.
BRODOSPLIT - BSO / NAVAL AND SPECIAL VESSEL SHIPYARD Ltd.
Put Supavla 21, 21001 SPLIT, Croatia

Phone: +385 (0)21 382 784, 391 173

Fax: +385 (0)21 382 409

E-mail: brodosplit-bso@bso.brodosplit.hr





SEARCH AND RESCUE CRAFT

SIDE VIEW

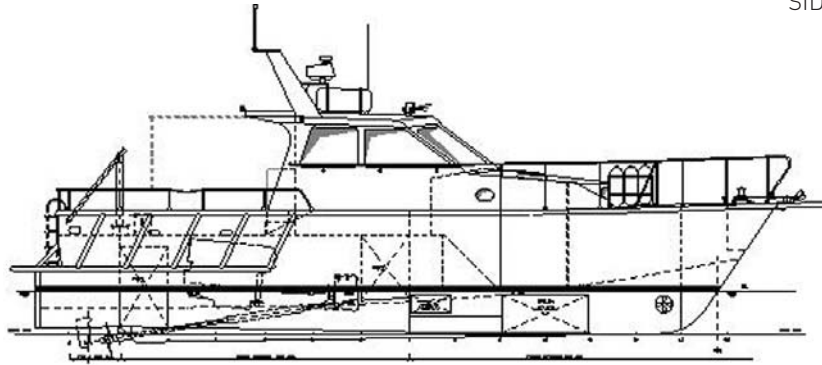

MAIN DECK

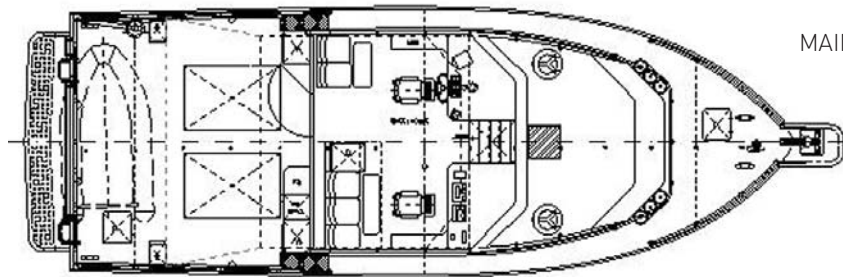

TWEEN DECK

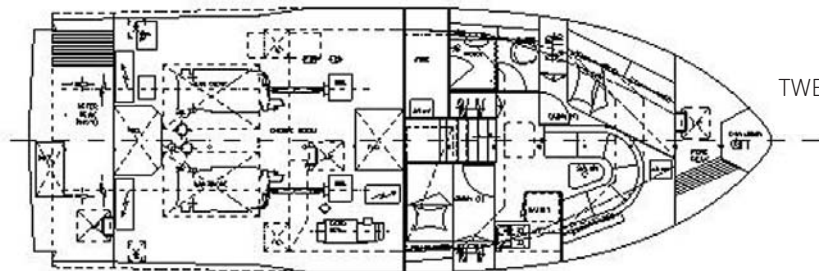



CAR & PASSENGER FERRY 138

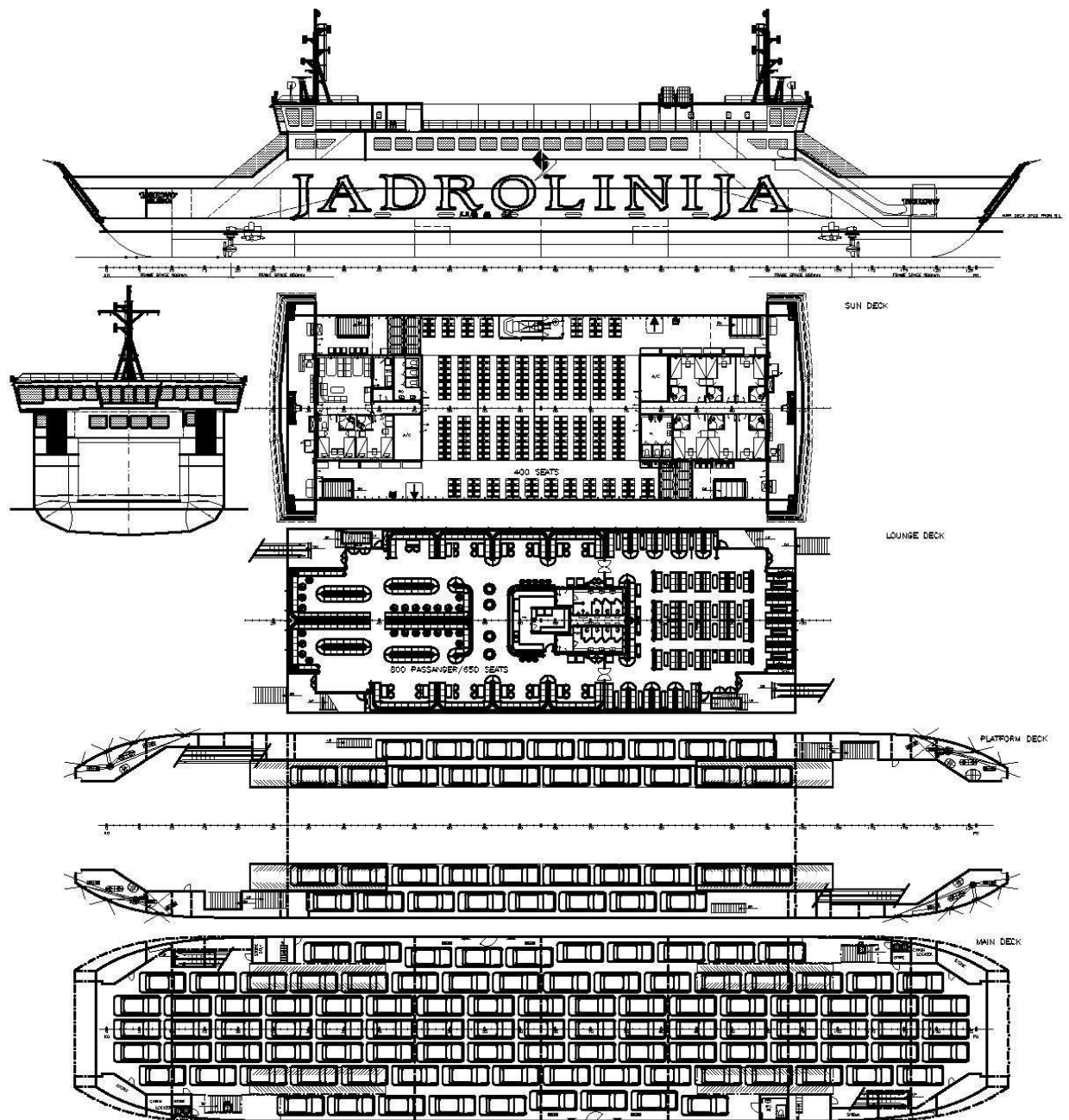



CAR & PASSENGER FERRY 100

YARD 599 - "SUPETAR"

YARD 503 - "CRES "

Owner:

"JADROLINIJA" - Rijeka, CROATIA

MAIN CHARACTERISTICS:

Length, over all	abt. 87.60 m
Length, (Lpp)	80.00 m
Breadth	17.50 m
Hight, up to main deck	3.70 m
Draught, max.	2.40 m

Carrying capacity:

Passengers	600, from which 240 in close salon
Crew	8 members
Cars	100 or 12 trailers of 18 m, 40 t each

Vessel's primary mission is transportation of passengers and vehicles at short routes and designed as Ro-Ro and passenger ship for equal navigate in both directions ("double ended").

Vessel is classed by Croatian Register of Shipping (CRS) as:

* 50 A1 M1 AUT1 IWS Ro-Ro Passenger Ferry for navigational area 6, voyage lasting up to 120 min., capable to carry packed dangerous cargo of the following classes: 1 (explosives), 2 (gases), 3 (inflammable liquids).

Vessel is with open space (garage) for vehicles

(cars) on main deck and with two ramps (stern and bow 1 each).

Vessel has excellent manoeuvrability due to propulsion system with 4 diesel main engines (4 x 400 kW) which are drive direct 4 feat propulsors with crank wings, two sets on stern and two sets on bow.

Propulsion engines, propulsors and diesel generators are accommodation in two engine rooms, one on aft and one on bow.

Ship's speed in trial conditions (easily sea and wind below 2 Bf, clean hull) is 11,5 knots on 2,2 m draught.



BRODOSPLIT - BRODOGRADILIŠTE SPECIJALNIH OBJEKATA d.o.o.

BRODOSPLIT - BSO / NAVAL AND SPECIAL VESSEL SHIPYARD Ltd.

Put Supavla 21, 21001 SPLIT, Croatia

Phone: +385 (0)21 382 784, 391 173

Fax: +385 (0)21 382 409

E-mail: brodosplit-bso@bso.brodosplit.hr





CAR & PASSENGER FERRY 100

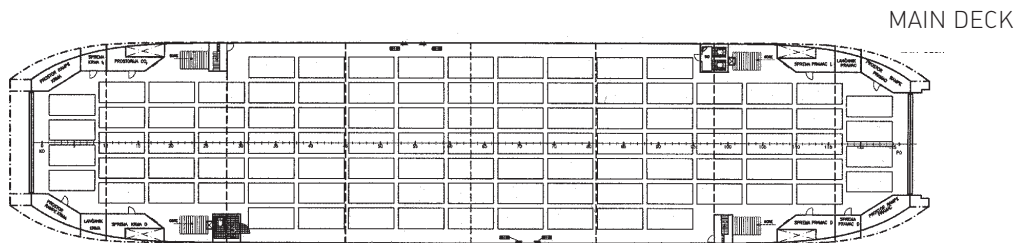
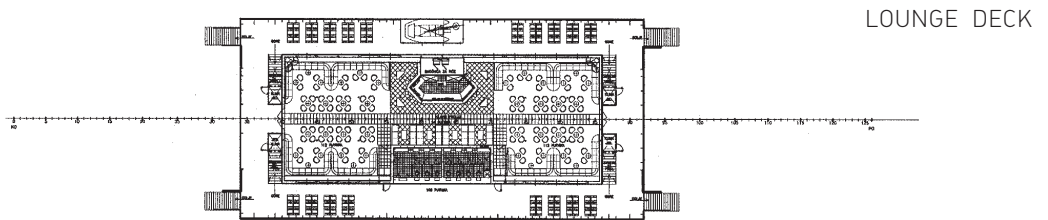
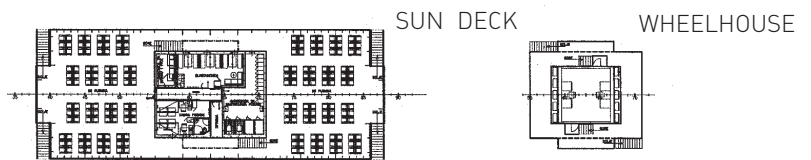
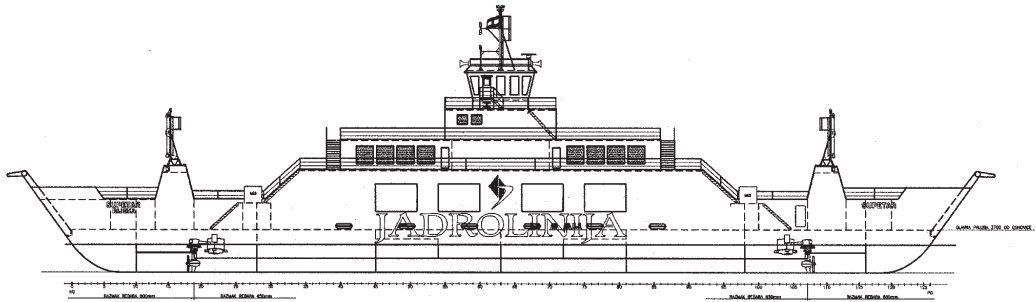



PASSENGER FERRY 20.76m

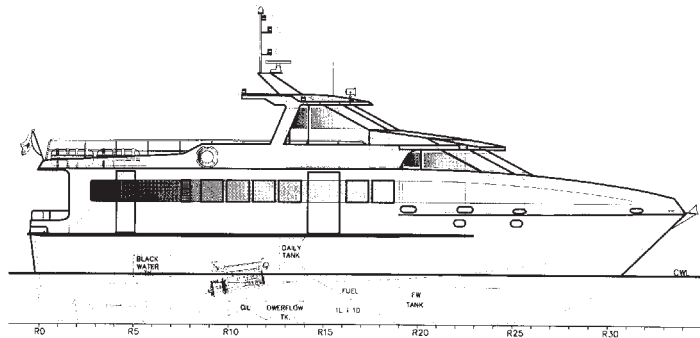

MAIN DECK

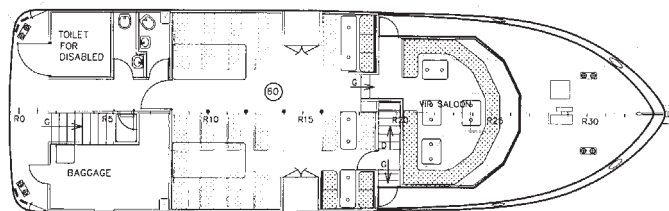

UPPER DECK

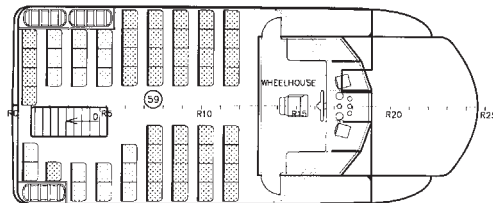

BELOW DECK

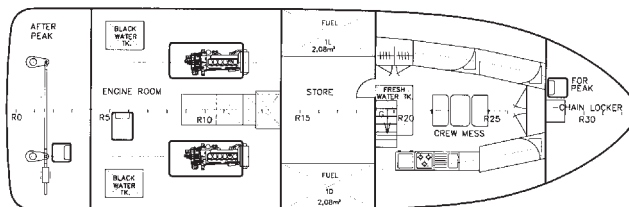



FAST ALUMINIUM WORKBOAT

YARD 584 - "PLOVPUT - 1"

YARD 593 - 598 - "PLOVPUT - 2-7"

Owner:

"PLOVPUT" d.o.o. Split, CROATIA

MAIN CHARACTERISTICS:

Length, over all 14.45 m
Length, hull without platforms 13.10 m

Breadth, max. without fenders 4.64 m
Draught, max. 1.15 m

Fast workboat's primary task is maintenance of maritime signalling devices and objects, such as buoys and lighthouses, transportation of lighthouse's crew and cargo supply. Open working deck area at stern is equipped with electro-hydraulic crane. Wheelhouse and accommodation spaces are air-conditioned.

Fast workboat is built according to rules of Croatian Register of Shipping for boats for commercial purposes. It is made of sea resistant aluminium alloy (AlMg4,5Mn), longitudinally framed, welded construction. Furthermore, damaged stability requirements are satisfied.

Two four-strokes diesel engines, turbocharged, electrically started, mechanically regulated revolution, maximal engine brake power 2 x 275 kW, enable service speed of 23 knots.

V-type gearboxes are reversible. Propulsion plant is remotely controlled from wheelhouse control console. Electrical power is provided from batteries (24 V DC) and from diesel generator (220 V, 50 Hz, 9 kW).

Boat is equipped with VHF radio telephone for external communication. Navigation system consists of: radar, GPS, magnetic compass, echo sounder and speed log. Accommodation is provided for 3 crew members and 9 passengers. In addition, there are 4 cabin berths and

4 auxiliary berths.

Maximal stern working deck area load is 3 t. Electro-hydraulic crane, of knuckle type, is mounted at stern deck, portside. Maximal crane load is 1,5 tm. Fuel tanks capacity enables action radius of 400 nautical miles, at 23 knots speed. Stores enable 7 days autonomy.

This fast workboat is first craft built (from development program of building fast craft at our shipyard). Design was particularly carefully developed, because of specific purpose of workboat and high technical design requirements regarding speed, safety, seaworthiness and comfort, load carrying capacity and action radius. Finally, it resulted in optimal fast workboat design.

At the beginning of fast workboat design development, the idea was to use it as a basis for various design variants, depending of boat's task. Without changing basic parameters of boat's design, and only changing above water parts, various variants are obtained, such as:

- fast passenger boat
- ambulance boat
- oil spill control boat
- luxury boat
- patrol boat, etc.



BRODOSPLIT - BRODOGRADILIŠTE SPECIJALNIH OBJEKATA d.o.o.

BRODOSPLIT - BSO / NAVAL AND SPECIAL VESSEL SHIPYARD Ltd.

Put Supavla 21, 21001 SPLIT, Croatia

Phone: +385 (0)21 382 784, 391 173

Fax: +385 (0)21 382 409

E-mail: brodosplit-bso@bso.brodosplit.hr





FAST ALUMINIUM WORKBOAT

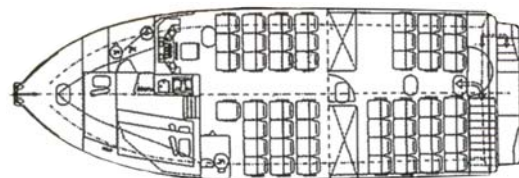
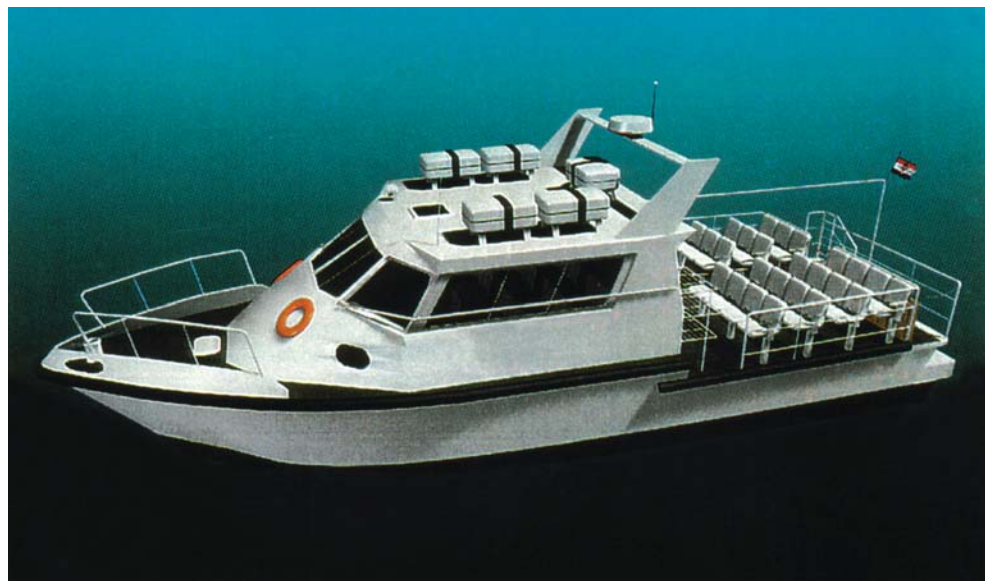



SEARCH AND RESCUE VESSEL

YARD 587 - "POJIŠAN"

YARD 588 - "VID"

YARD 589 - "ŠIBENIK"

YARD 590 - "DANČE"

Owner:

REPUBLIC OF CROATIA
MINISTRY OF MARITIME AFFAIRS, TRANSPORT
AND COMMUNICATIONS

MAIN CHARACTERISTICS:

Length, over all	18.24 m
Length, hull	18.08 m
Breadth, max.	5.90 m
Draught, max.	1.60 m

Search and Rescue Vessel's primary task is search, rescue and retrieve of survivors and sea surveillance.

The vessel is capable of berthing to every type of vessels in order to retrieve patients, delivery of devices and equipment and embarkation of maritime authorities.

Vessel is built according to Croatian Register of Shipping Rules, and classed:

Javni brod SD	Hull	* 90 A1 3
	Engine	* M1 AUT3

Hull is made of steel, and superstructure of sea resistant aluminium alloy; welded construction. Damaged stability requirements are also satisfied.

Service speed of 24 knots are enabled by propul-

sion system consisting of: two 4-stroke diesel engines, each having MCR 610 kW, reversible gearboxes, and fixed pitch 5-bladed propellers. Control consoles are in the wheelhouse and at flying bridge.

Electric resources are: 24V DC batteries and 220V, 50Hz diesel generator.

Communication and navigation system includes: VHF radiotelephone, radar, GPS, autopilot, compass, echosounder and speed log.

Accommodation is provided for 4 crew and 10 survivors with resuscitation equipment sets.

Fuel tank capacities enable 300 NM range at 20 knots.

Provisions are sufficient for 7 days autonomy.



BRODOSPLIT - BRODOGRADILIŠTE SPECIJALNIH OBJEKATA d.o.o.

BRODOSPLIT - BSO / NAVAL AND SPECIAL VESSEL SHIPYARD Ltd.

Put Supavla 21, 21001 SPLIT, Croatia

Phone: +385 (0)21 382 784, 391 173

Fax: +385 (0)21 382 409

E-mail: brodosplit-bso@bso.brodosplit.hr





SEARCH AND RESCUE VESSEL

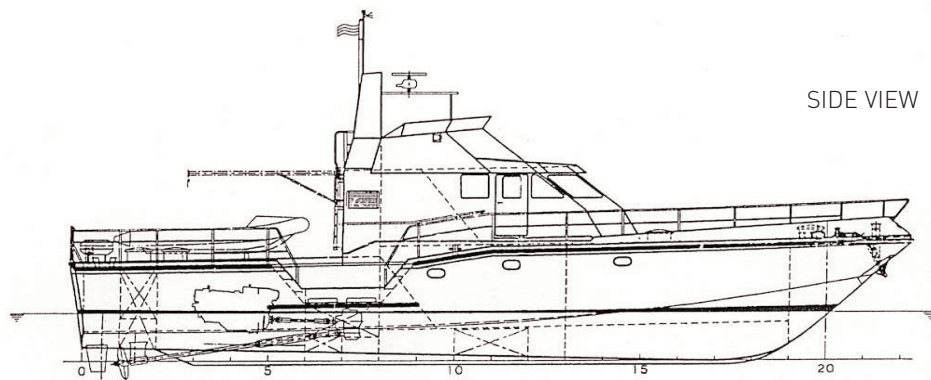

SIDE VIEW

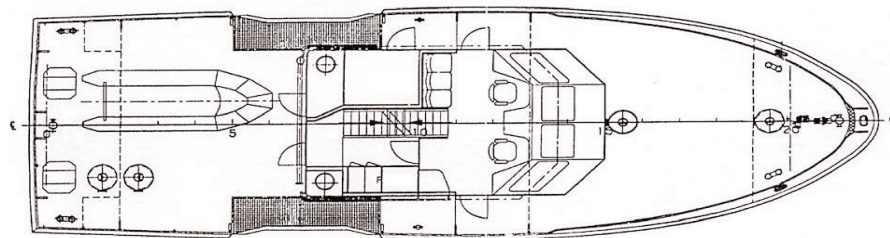

MAIN DECK

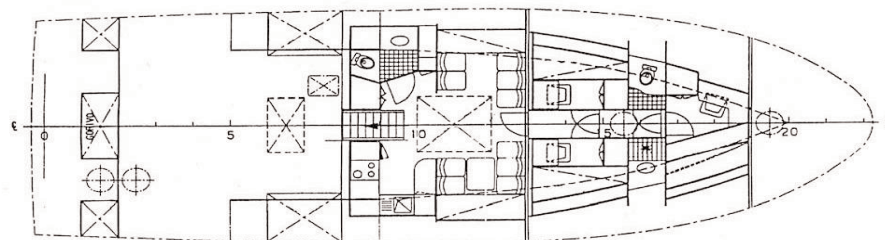

TWEEN DECK





CAR & PASSENGER FERRY 36

YARD 585 - "LASLOVO"

YARD 586 - "STON"

Owner:

"JADROLINIJA" - Rijeka, CROATIA

MAIN CHARACTERISTICS:

Length, over all	abt. 41.20 m
Breadth, moulded	16.00 m
Breadth of demi-hull, moulded	5.20 m
Depth, moulded	3.60 m
Draught, moulded	2,30 m

Carrying capacity:

Passengers	150
Cars	36 or 3 trailers of 16 m, 40 t each
Speed	9.5 knots

Vessel's primary mission is transportation of passengers and vehicles at short routes.

Vessel is classed by Croatian Register of Shipping as:

* 50 A1 M1 AUT 2 IWS Ro-Ro Passenger Ferry, navigational area 6, voyage lasting up to 1 hour, capable to carry packed dangerous cargo of the following classes : 1 (explosives), 2 (gases), 3 (flammable liquids).

Vessel is of catamaran type, with open space for vehicles on main deck, bow and stern ramp.

Vessel has excellent manoeuvrability due to electro propulsion system with controllable electric



BRODOSPLIT - BRODOGRADILIŠTE SPECIJALNIH OBJEKATA d.o.o.

BRODOSPLIT - BSO / NAVAL AND SPECIAL VESSEL SHIPYARD Ltd.

Put Supavla 21, 21001 SPLIT, Croatia

Phone: +385 (0)21 382 784, 391 173

Fax: +385 (0)21 382 409

E-mail: brodosplit-bso@bso.brodosplit.hr





CAR & PASSENGER FERRY 36

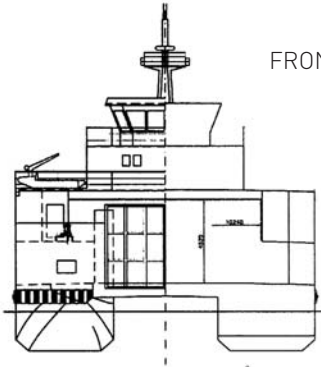

FRONT VIEW

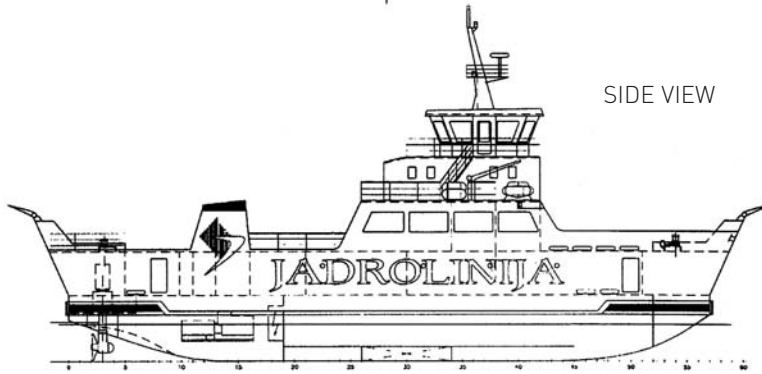

SIDE VIEW

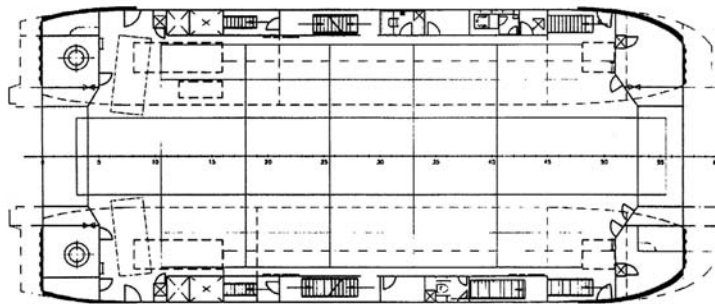

MAIN DECK

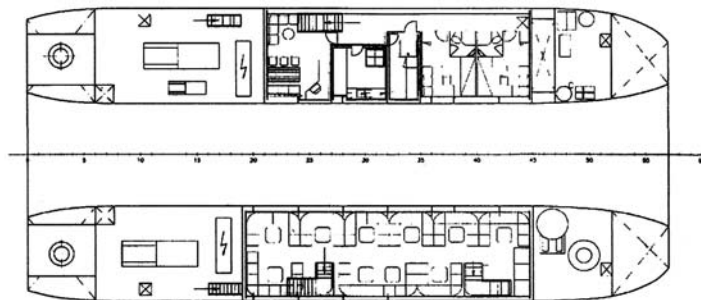

TWEEN DECK

