

Car Passenger Ferry

2,200 passengers / 600 cars

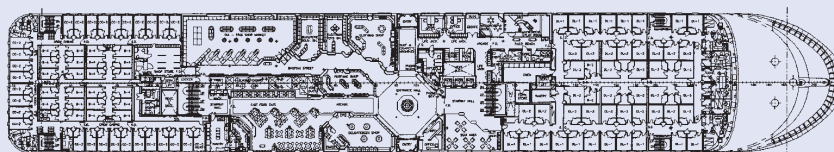
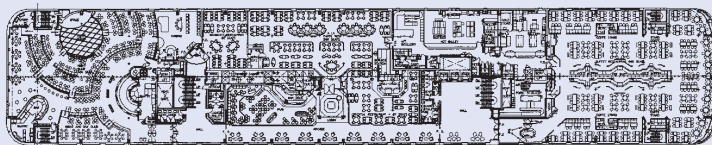
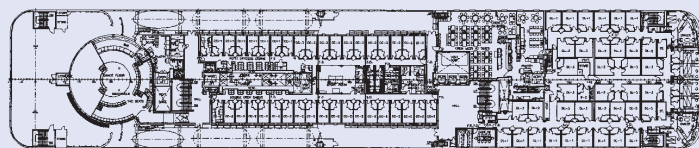
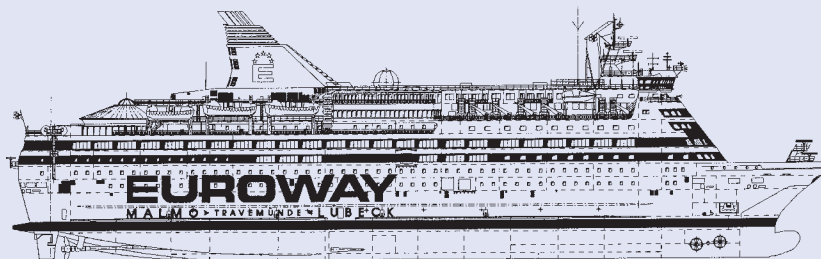

FERRIES & RO-RO, YACHTS, HIGH SPEED BOATS

Builder: Shipyard **BRODOSPLIT / 372**
Name: **AMORELLA, ISABELLA, CROWN OF SCANDINAVIA, FRANS SUELL**
Owner / Flag: Sea Link Shipping AB Malmo / Sweden.
Sister vessel: 356, 357, 373
Delivered: 1988, 1989, 1992, 1994

FRANS SUELL is a modern Car passenger ferry intended for the short international voyages and built according to highest Scandinavian standards for such type of vessel, vertically divided into 12 decks from the tank top to the wheel house level. Deck No. 3 and hoistable deck No. 4 are arranged for the loading of cars and lorries through the stern and bow ramps. Main car deck No. 3 is divided into 8 lanes. The propulsion is achieved by two shafts fitted with CP propellers and driven by twin coupled medium speed diesel engines.

Classification: Rules and Regulations: DNV; \pm 1A1 Car Ferry A, Ice Class 1A*, MCDK, EO bis, pwdk Swedish National and International Rules and Regulations related to this type of vessel.

Length over all	169.40 m
Length btw perp	149.80 m
Breadth moulded, deck 3	27.60 m
Breadth maximum	28.20 m
Depth moulded, deck 3	8.50 m
Draught moulded	6.25 m
Deadweight, at draught of 6.25 m	2,960 tons
Gross tonnage	35,285
Net tonnage	20,887
Main engines:	four S.E.M.T.-PIELSTIC MCR: 4 X 5,940 kW/520 rpm
Trial speed at 73.6% MCR and 6.0 m draught	21.50 knots

Capacities

Garage: cars lane length, total (deck 3 & 4)	2,200 m
trailers lane length, total deck 3	1,000 m
Accommodation: cabins, total	794
couchettes, total	11
Passengers: in cabins	2,172
in couchettes	44
Total:	2,216
Crew:	193

Provisions

Heavy fuel oil	683 m ³
Diesel fuel oil	164 m ³
Lubrication Oil	114 m ³
Fresh Water	490 m ³
M.E. daily fuel oil consumption (ISO condition)	79 t

Auxiliaries

- four electric generators, diesel driven 4 x 500 kW/750 rpm
- two oil fired steam boilers 2 x 5 t/h at 7 bar
- one exhaust gas heated, steam economizer 1 x 8 t/h at 7 bar
- two sludge burning steam boilers

CP propellers, two rudders fitted with hydraulically driven rotor and two bow thrusters are making the vessel extremely manoeuvrable in the restricted waters of the Baltic sea.

Antiheeling tanks system and fin stabilisers are used during loading /unloading operations and sailing of the vessel.

Hull structure is made of mild and high tensile steel and aluminium above 10th deck level, utilizing the light weight in accordance with the strict requirements for the vessel's draft and stability.

Accommodation is mainly divided into cabin area, built and installed in prefabricated modular blocks, and passenger's public areas such as high class restaurants, self service restaurants, huge shopping area, conference room and auditorium, disco club, night club, pubs, etc.

Number of sitting places in different restaurants, being in total approximately 2,200 corresponds to the number of passengers.

The biggest and most attractive are:

Oriental restaurant	82 seats
Night club	509 seats
A la Carte	206 seats
Buffet	466 seats
Banquet	82 seats
Pub	115 seats
Disco club	184 seats

In addition to the above, different larger and smaller conference rooms are furnished with more than 300 seats, the biggest of which is Auditorium with 150 sitting places. The most modern audio visual and other equipment is fitted, giving to the ship a large number of attractive facilities.